

Submersible Mixer:

Flow Rate:

Motor Output:

MR (50Hz/Without Guide Ring Type)

2.0 - 42.0m³/min

0.25 - 7.5kW

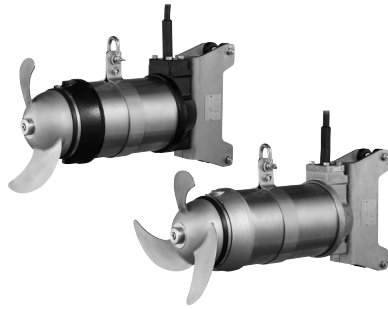

The MR-series is a submersible mixer designed to generate a powerful jet of water using a propeller that is specially shaped for high efficiency and directly coupled to a submersible motor. It can be used for either aerobic/aeration treatment that mixes water and air, or anaerobic treatment that does not mix air into the water. The MR-series is available in wide variations, including cast iron or cast stainless steel construction, as well as configured without a guide ring that enhances the mixing effect or with it, which increases the flow regulating effect. When used in combination with lifting equipment (optional), the mixer can be easily inspected and serviced without entering the tank.

Selection Table (Without Guide Ring Type)

Model	Motor Output kW	Pole	Propeller Rotation Speed min ⁻¹	Flow Rate m ³ /min	Fresh Water Mixing Output kW	Reaction Force N	Dry Weight kg	50Hz
								Propeller Nominal Dia. mm
MR21NF250	0.25	4	1420	2.0	0.12	50	24	155
MR21NF400	0.4	4	1420	2.8	0.17	80	24	185
MR21NF750	0.75	4	1410	3.6	0.35	130	24	190
MR2521EC/CR	0.75	6	942	5.0	0.62	170	28	270
MR31NF/NR1.5	1.5	6	910	7.5	1.0	195	36	300
MR32NF/NR1.5	1.5	6	910	7.8	1.1	210	36	300
MR33NF/NR1.5	1.5	6	910	9.8	1.2	295	36	300
MR31NF/NR2.8	2.8	6	915	10.9	2.1	395	46	300
MR32NF/NR2.8	2.8	6	915	11.8	2.3	420	46	300
MR33NF/NR2.8	2.8	6	915	13.0	2.5	500	46	300
MR41NF/NR3.0	3	8	730	11.6	2.5	330	112/122	400
MR42NF/NR3.0	3	8	730	13.0	2.6	465	112/122	400
MR43NF/NR3.0	3	8	730	15.0	2.7	570	112/122	400
MR41NF/NR4.0	4	8	710	17.4	3.4	610	112/122	400
MR42NF/NR4.0	4	8	710	19.0	3.6	660	112/122	400
MR61NF/NR5.0	5	12	483	27.0	3.7	900	144/150	600
MR62NF/NR5.0	5	12	483	32.0	4.1	1200	144/150	600
MR63NF/NR5.0	5	12	483	38.0	4.7	1500	144/150	600
MR61NF/NR7.5	7.5	12	483	32.0	5.6	1200	164/170	600
MR62NF/NR7.5	7.5	12	483	38.0	6.1	1500	164/170	600
MR63NF/NR7.5	7.5	12	483	42.0	6.7	1800	164/170	600

- TOMR type lifting equipment is also available. For details, contact your dealer.
- Weights of MR400/650-series is shown in NF (cast iron)/NR (stainless steel casting) type.

Model Number Designation

MR200-series

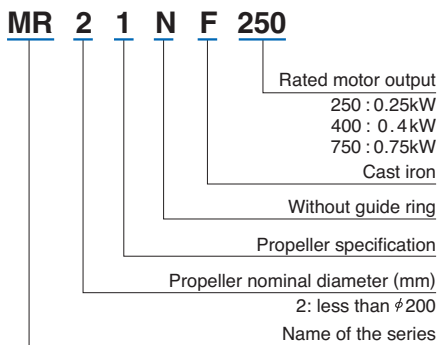

MR250-series

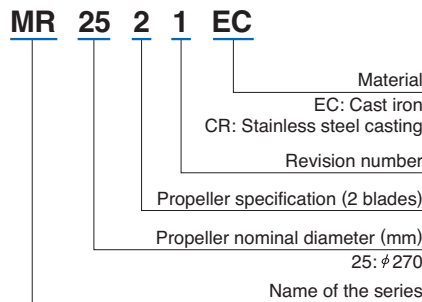

MR300/400/650-series

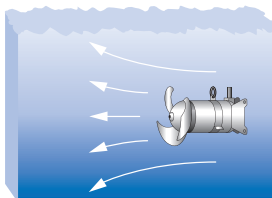
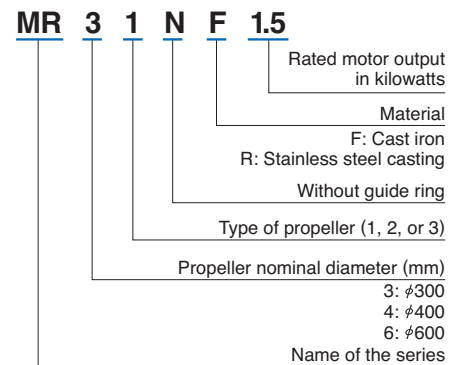

Without Guide Ring type improves the mixing effect while increasing water flow.

Submersible Mixer:

Flow Rate:

Motor Output:

MR (60Hz/Without Guide Ring Type)

1.4 - 40.0m³/min

0.25 - 7.5kW

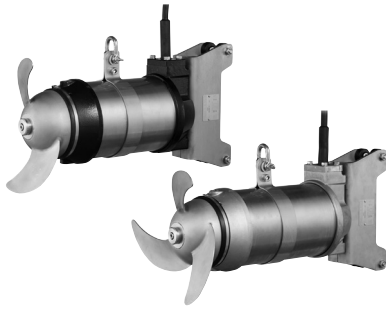

The MR-series is a submersible mixer designed to generate a powerful jet of water using a propeller that is specially shaped for high efficiency and directly coupled to a submersible motor. It can be used for either aerobic/aeration treatment that mixes water and air, or anaerobic treatment that does not mix air into the water. The MR-series is available in wide variations, including cast iron or cast stainless steel construction, as well as configured without a guide ring that enhances the mixing effect or with it, which increases the flow regulating effect. When used in combination with lifting equipment (optional), the mixer can be easily inspected and serviced without entering the tank.

Selection Table (Without Guide Ring Type)

Model	Motor Output kW	Pole	Propeller Rotation Speed min ⁻¹	Flow Rate m ³ /min	Fresh Water Mixing Output kW	Reaction Force N	Dry Weight kg	60Hz
								Propeller Nominal Dia. mm
MR21NF250	0.25	4	1700	1.4	0.08	40	24	145
MR21NF400	0.4	4	1700	1.8	0.13	60	24	155
MR21NF750	0.75	4	1690	3.2	0.28	110	24	185
MR2521EC/CR	0.75	6	1126	4.4	0.68	160	28	240
MR31NF/NR1.5	1.5	6	1085	9.3	1.2	260	36	300
MR32NF/NR1.5	1.5	6	1085	9.6	1.3	285	36	300
MR31NF/NR2.8	2.8	6	1090	11.9	2.1	430	46	300
MR32NF/NR2.8	2.8	6	1090	13.1	2.5	535	46	300
MR41NF/NR3.0	3	8	870	14.1	2.5	485	112/122	400
MR42NF/NR3.0	3	8	870	16.4	2.8	665	112/122	400
MR41NF/NR4.0	4	8	840	18.6	3.8	795	112/122	400
MR61NF/NR5.0	5	12	578	25.0	3.7	800	144/150	600
MR62NF/NR5.0	5	12	578	32.0	4.6	1300	144/150	600
MR61NF/NR7.5	7.5	12	577	32.0	5.4	1300	164/170	600
MR62NF/NR7.5	7.5	12	577	40.0	6.4	1700	164/170	600

- TOMR type lifting equipment is also available. For details, contact your dealer.
- Weights of MR400/650-series is shown in NF (cast iron)/NR (stainless steel casting) type.

Model Number Designation

MR200-series

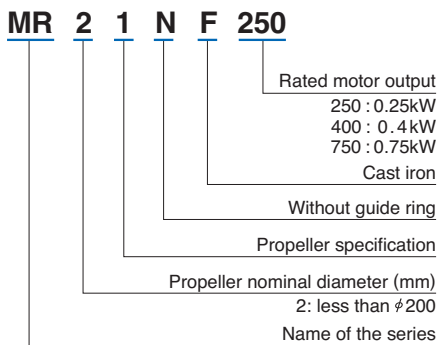

MR250-series

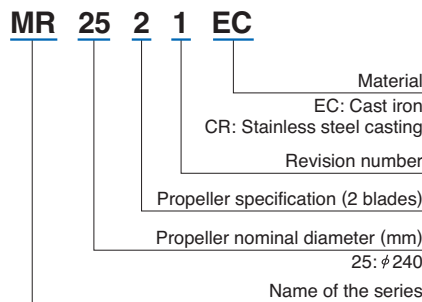

MR300/400/650-series

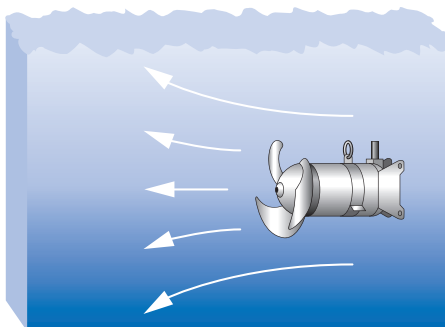
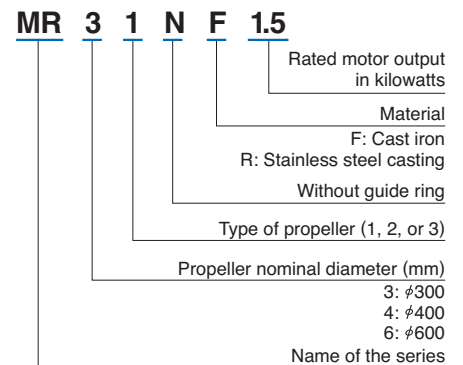

Without Guide Ring type improves the mixing effect while increasing water flow.

Submersible Mixer:
MR (50Hz/With Guide Ring Type)
Flow Rate:
7.3 - 42.0m³/min
Motor Output:
1.5 - 7.5kW

The MR-series is a submersible mixer designed to generate a powerful jet of water using a propeller that is specially shaped for high efficiency and directly coupled to a submersible motor. It can be used for either aerobic/aeration treatment that mixes water and air, or anaerobic treatment that does not mix air into the water. The MR-series is available in wide variations, including cast iron or cast stainless steel construction, as well as configured without a guide ring that enhances the mixing effect or with it, which increases the flow regulating effect. When used in combination with lifting equipment (optional), the mixer can be easily inspected and serviced without entering the tank.

Selection Table (With Guide Ring Type)

Model	Motor Output kW	Pole	Propeller Rotation Speed min ⁻¹	Flow Rate m ³ /min	Fresh Water Mixing Output kW	Reaction Force N	Dry Weight kg	50Hz
								Propeller Nominal Dia. mm
MR31GF/GR1.5	1.5	6	910	7.3	0.9	185	46	300
MR32GF/GR1.5	1.5	6	910	7.7	1.0	200	46	300
MR33GF/GR1.5	1.5	6	910	9.6	1.2	285	46	300
MR31GF/GR2.8	2.8	6	915	10.7	2.1	385	56	300
MR32GF/GR2.8	2.8	6	915	11.5	2.2	410	56	300
MR33GF/GR2.8	2.8	6	915	12.7	2.4	490	56	300
MR41GF/GR3.0	3	8	730	11.3	2.4	235	125/135	400
MR42GF/GR3.0	3	8	730	12.6	2.5	375	125/135	400
MR43GF/GR3.0	3	8	730	14.4	2.6	435	125/135	400
MR41GF/GR4.0	4	8	710	16.6	3.2	475	125/135	400
MR42GF/GR4.0	4	8	710	18.1	3.3	540	125/135	400
MR61GF/GR5.0	5	12	483	27.0	3.8	900	154/160	600
MR62GF/GR5.0	5	12	483	32.0	4.1	1200	154/160	600
MR63GF/GR5.0	5	12	483	38.0	4.7	1500	154/160	600
MR61GF/GR7.5	7.5	12	483	32.0	5.5	1200	174/180	600
MR62GF/GR7.5	7.5	12	483	38.0	6.0	1500	174/180	600
MR63GF/GR7.5	7.5	12	483	42.0	6.4	1800	174/180	600

- TOMR type lifting equipment is also available. For details, contact your dealer.
- Weights of MR400/650-series is shown in GF (cast iron)/GR (stainless steel casting) type.

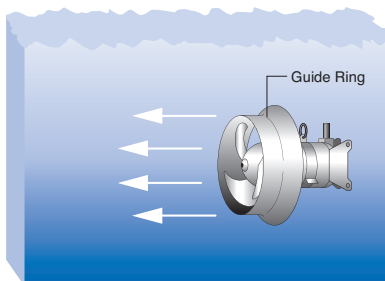
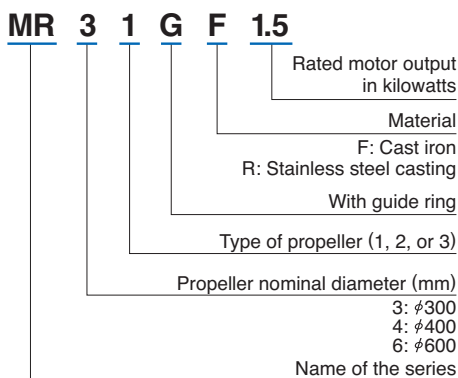
Model Number Designation

With Guide Ring type provides an excellent flow regulating effect.

Submersible Mixer:	Flow Rate:	Motor Output:
MR (60Hz/With Guide Ring Type)	9.0 - 40.0m³/min	1.5 - 7.5kW



The MR-series is a submersible mixer designed to generate a powerful jet of water using a propeller that is specially shaped for high efficiency and directly coupled to a submersible motor. It can be used for either aerobic/aeration treatment that mixes water and air, or anaerobic treatment that does not mix air into the water. The MR-series is available in wide variations, including cast iron or cast stainless steel construction, as well as configured without a guide ring that enhances the mixing effect or with it, which increases the flow regulating effect. When used in combination with lifting equipment (optional), the mixer can be easily inspected and serviced without entering the tank.

Selection Table (With Guide Ring Type)

Model	Motor Output kW	Pole	Propeller Rotation Speed min ⁻¹	Flow Rate m ³ /min	Fresh Water Mixing Output kW	Reaction Force N	Dry Weight kg	60Hz
								Propeller Nominal Dia. mm
MR31GF/GR1.5	1.5	6	1085	9.0	1.1	245	46	300
MR32GF/GR1.5	1.5	6	1085	9.4	1.2	275	46	300
MR31GF/GR2.8	2.8	6	1090	11.5	2.0	420	56	300
MR32GF/GR2.8	2.8	6	1090	12.6	2.3	525	56	300
MR41GF/GR3.0	3	8	870	13.4	2.4	345	125/135	400
MR42GF/GR3.0	3	8	870	15.6	2.7	530	125/135	400
MR41GF/GR4.0	4	8	840	17.7	3.4	630	125/135	400
MR61GF/GR5.0	5	12	578	25.0	3.6	800	154/160	600
MR62GF/GR5.0	5	12	578	32.0	4.5	1300	154/160	600
MR61GF/GR7.5	7.5	12	577	32.0	5.4	1300	174/180	600
MR62GF/GR7.5	7.5	12	577	40.0	6.4	1700	174/180	600

- TOMR type lifting equipment is also available. For details, contact your dealer.
- Weights of MR400/650-series is shown in GF (cast iron)/GR (stainless steel casting) type.

Model Number Designation

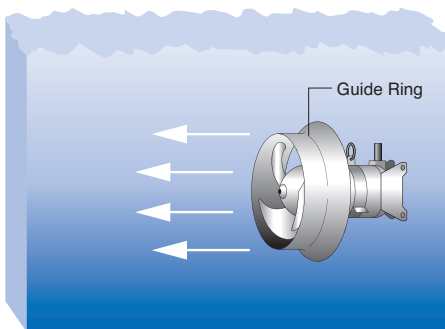
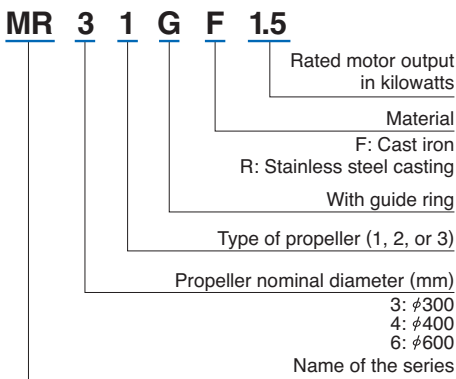

With Guide Ring type provides an excellent flow regulating effect.

DIMENSIONS

Model MR21NF250 to MR62NF/NR7.5

MR-series
(Without Guide Ring Type)

Without Guide Ring Type

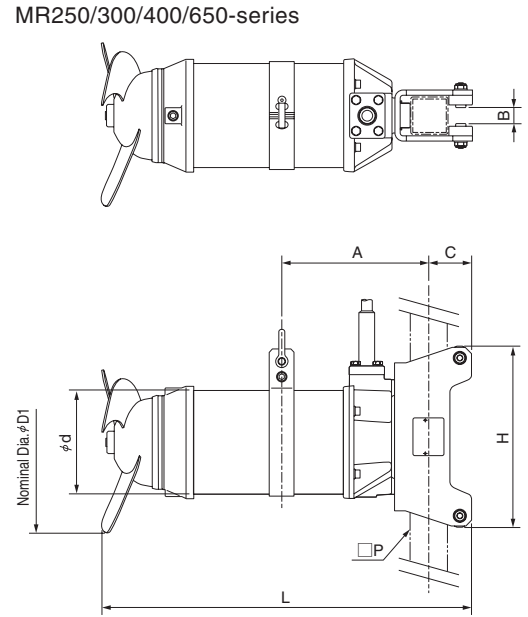
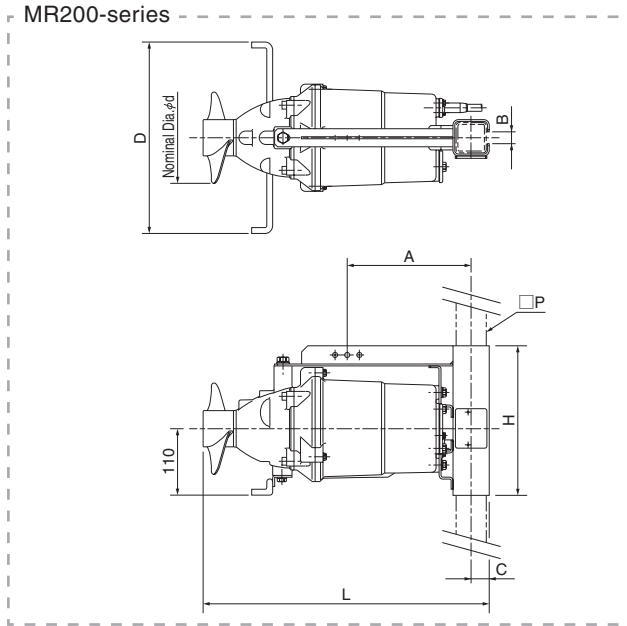

50Hz

Unit: mm

Model	D	D1	d	L	H	A	B	C	P
MR21NF250	317	—	155	473	247	205	20	30	50
MR21NF400	317	—	185	473	247	205	20	30	50
MR21NF750	317	—	190	473	247	205	20	30	50
MR2521EC/CR	—	270	165	470	258	177	21	67	50
MR31NF/NR1.5	—	300	168	556	294	210	26	70	60
MR32NF/NR1.5	—	300	168	557	294	210	26	70	60
MR33NF/NR1.5	—	300	168	560	294	210	26	70	60
MR31NF/NR2.8	—	300	168	600	294	240	26	70	60
MR32NF/NR2.8	—	300	168	608	294	240	26	70	60
MR33NF/NR2.8	—	300	168	608	294	240	26	70	60
MR41NF/NR3.0	—	400	—	668	300	285	26	70	60
MR42NF/NR3.0	—	400	—	668	300	285	26	70	60
MR43NF/NR3.0	—	400	—	668	300	285	26	70	60
MR41NF/NR4.0	—	400	—	668	300	285	26	70	60
MR42NF/NR4.0	—	400	—	686	300	285	26	70	60
MR61NF/NR5.0	—	600	—	795	380	300	45	98	60
MR62NF/NR5.0	—	600	—	800	380	300	45	98	60
MR63NF/NR5.0	—	600	—	805	380	300	45	98	60
MR61NF/NR7.5	—	600	—	800	380	290	45	98	60
MR62NF/NR7.5	—	600	—	805	380	290	45	98	60
MR63NF/NR7.5	—	600	—	815	380	290	45	98	60

● Dimension " A " is a reference value.

60Hz

Unit: mm

Model	D	D1	d	L	H	A	B	C	P
MR21NF250	317	—	145	473	247	205	20	30	50
MR21NF400	317	—	155	473	247	205	20	30	50
MR21NF750	317	—	185	473	247	205	20	30	50
MR2521EC/CR	—	240	165	470	258	177	21	67	50
MR31NF/NR1.5	—	300	168	556	294	210	26	70	60
MR32NF/NR1.5	—	300	168	557	294	210	26	70	60
MR31NF/NR2.8	—	300	168	600	294	240	26	70	60
MR32NF/NR2.8	—	300	168	600	294	240	26	70	60
MR41NF/NR3.0	—	400	—	668	300	285	26	70	60
MR42NF/NR3.0	—	400	—	668	300	285	26	70	60
MR41NF/NR4.0	—	400	—	668	300	285	26	70	60
MR61NF/NR5.0	—	600	—	790	380	300	45	98	60
MR62NF/NR5.0	—	600	—	795	380	300	45	98	60
MR61NF/NR7.5	—	600	—	795	380	290	45	98	60
MR62NF/NR7.5	—	600	—	800	380	290	45	98	60

● Dimension " A " is a reference value.

DIMENSIONS

Model MR31GF/GR1.5 to MR62GF/GR7.5

MR-series
 (With Guide Ring Type)

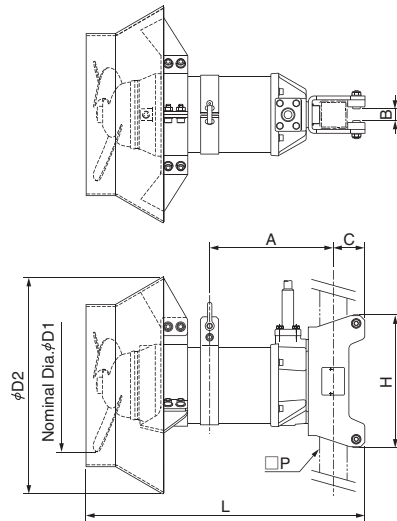
With Guide Ring Type

50Hz

Unit: mm

Model	D1	D2	L	H	A	B	C	P
MR31GF/GR1.5	300	479	576	294	255	26	70	60
MR32GF/GR1.5	300	479	576	294	255	26	70	60
MR33GF/GR1.5	300	479	576	294	255	26	70	60
MR31GF/GR2.8	300	479	616	294	275	26	70	60
MR32GF/GR2.8	300	479	616	294	275	26	70	60
MR33GF/GR2.8	300	479	616	294	275	26	70	60
MR41GF/GR3.0	400	572	691	300	300	26	70	60
MR42GF/GR3.0	400	572	691	300	300	26	70	60
MR43GF/GR3.0	400	572	691	300	300	26	70	60
MR41GF/GR4.0	400	572	691	300	300	26	70	60
MR42GF/GR4.0	400	572	691	300	300	26	70	60
MR61GF/GR5.0	600	780	825	380	325	45	98	60
MR62GF/GR5.0	600	780	825	380	325	45	98	60
MR63GF/GR5.0	600	780	825	380	325	45	98	60
MR61GF/GR7.5	600	780	825	380	325/315	45	98	60
MR62GF/GR7.5	600	780	825	380	325/315	45	98	60
MR63GF/GR7.5	600	780	825	380	325/315	45	98	60

● Dimension "A" is a reference value.

60Hz

Unit: mm

Model	D1	D2	L	H	A	B	C	P
MR31GF/GR1.5	300	479	576	294	255	26	70	60
MR32GF/GR1.5	300	479	576	294	255	26	70	60
MR31GF/GR2.8	300	479	616	294	275	26	70	60
MR32GF/GR2.8	300	479	616	294	275	26	70	60
MR41GF/GR3.0	400	572	691	300	300	26	70	60
MR42GF/GR3.0	400	572	691	300	300	26	70	60
MR41GF/GR4.0	400	572	691	300	300	26	70	60
MR61GF/GR5.0	600	780	825	380	325	45	98	60
MR62GF/GR5.0	600	780	825	380	325	45	98	60
MR61GF/GR7.5	600	780	825	380	325/315	45	98	60
MR62GF/GR7.5	600	780	825	380	325/315	45	98	60

● Dimension "A" is a reference value.